

last saved by: rob.gulierrez on: 01/10/2012 5:24:24 PM last plot: 02/10/2012 11:55:13 AM

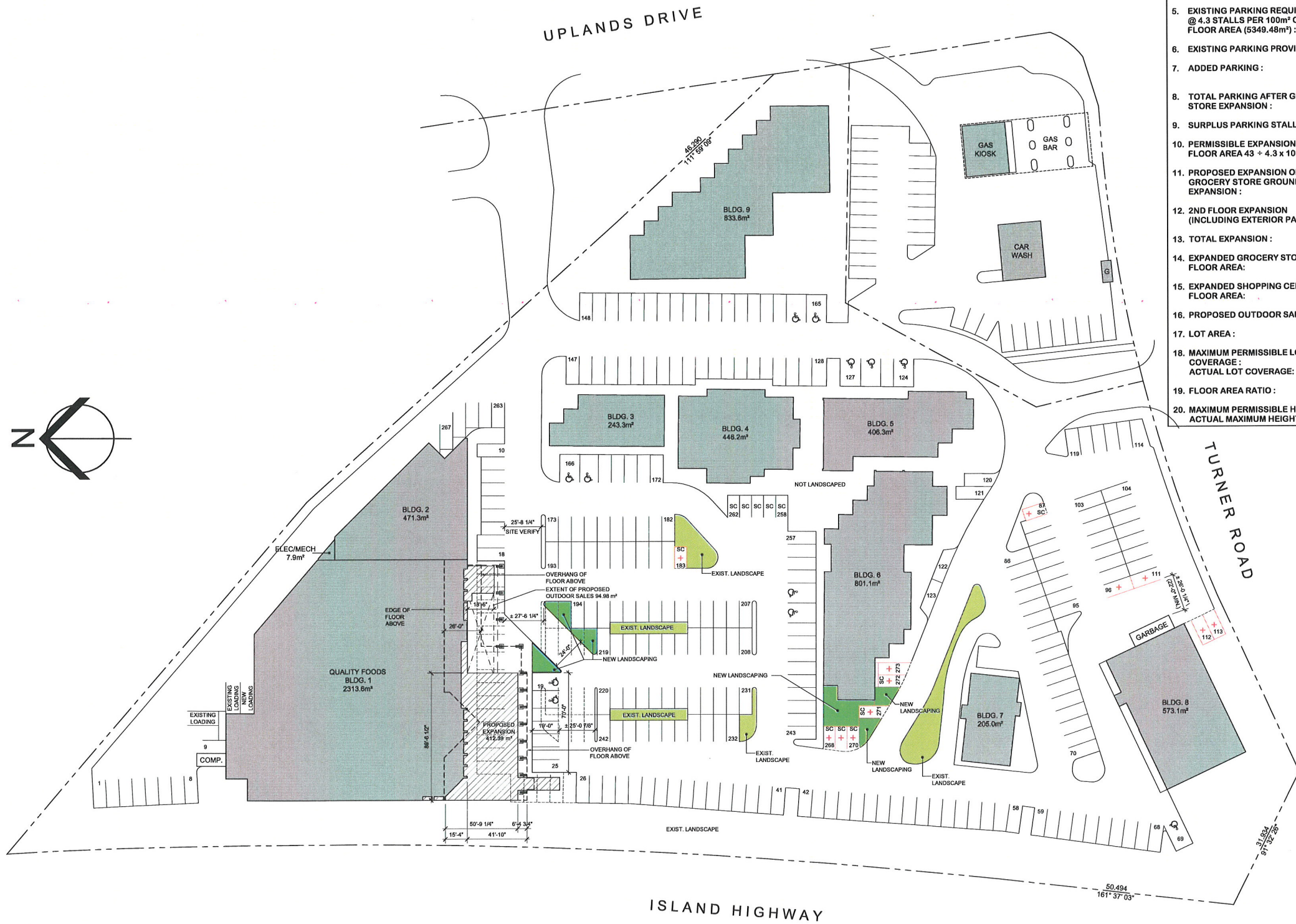

1 PROPOSED SITE PLAN  
A1.1

**SITE STATISTICS**

1. CIVIC ADDRESS :	1 - 5800 TURNER ROAD NANAIMO, B.C. V9T 6J4
2. LEGAL DESCRIPTION :	PARCEL IDENTIFIER 026-441-896 STRATA LOT 1, DISTRICT LOT 30, WELLINGTON DISTRICT, STRATA PLAN V155863. TOGETHER WITH AN INTEREST IN THE COMMON PROPERTY IN PROPORTION TO THE UNIT ENTITLEMENT OF THE STRATA LOT AS SHOWN ON FORM V.
3. EXISTING SHOPPING CENTRE GROSS FLOOR AREA (GFA) :	6,293.5m² / 67,744 sf
4. EXISTING GROCERY STORE GFA:	2,313.6m² / 24,903.38 sf
5. EXISTING PARKING REQUIRED @ 4.3 STALLS PER 100m² OF NET FLOOR AREA (5349.48m²) :	230 STALLS
6. EXISTING PARKING PROVIDED :	287 STALLS
7. ADDED PARKING :	12 STALLS (NEW TOTAL 299 STALLS)
8. TOTAL PARKING AFTER GROCERY STORE EXPANSION :	273 STALLS
9. SURPLUS PARKING STALLS :	43 STALLS
10. PERMISSIBLE EXPANSION OF GROSS FLOOR AREA 43 ÷ 4.3 x 100m² x 115% :	1150.00m² / 12,378.50 sf
11. PROPOSED EXPANSION OF BLDG. 1, GROCERY STORE GROUND FLOOR EXPANSION :	375.73m² / 4,044.36 sf
12. 2ND FLOOR EXPANSION (INCLUDING EXTERIOR PATIOS) :	670.61m² / 7,218.47 sf
13. TOTAL EXPANSION :	1,046.34m² / 11,262.83 sf
14. EXPANDED GROCERY STORE FLOOR AREA:	3,359.94m² / 36,166.21 sf
15. EXPANDED SHOPPING CENTRE FLOOR AREA:	7,339.84m² / 79,006.83 sf
16. PROPOSED OUTDOOR SALES :	94.98m² / 1,022.36 sf
17. LOT AREA :	26027.34m² / 280,156 sf
18. MAXIMUM PERMISSIBLE LOT COVERAGE :	50%
ACTUAL LOT COVERAGE:	28.38%
19. FLOOR AREA RATIO :	0.28 FSR
20. MAXIMUM PERMISSIBLE HEIGHT:	14.00m / 45.93'
ACTUAL MAXIMUM HEIGHT:	9.14m / 30'-0"

NOTES

REVISIONS / ISSUES      DATE

Client Name  
**Quality Foods  
Northridge  
Centre**  
101 - 5800 Turner Road  
Nanaimo, BC V9T 6J4  
**IAN ANNAND  
architect**  
NARAMATA, BC V0H1N0  
250 . 496 . 5252  
**PROPOSED  
SITE PLAN**

SCALE: 1" = 30'-0"  
DRAWN BY: PAR  
REVIEWED: PAR  
PROJECT No. **1080**  
SHEET No. A - 1.1